

测针

用于数显指示表、指针式指示表和线性测微计的选项

性能参数

钢球测针

标准测针

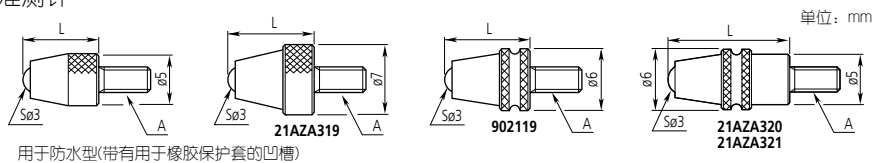

用于防水型(带有用于橡胶保护套的凹槽)

A: M2.5x0.45

L	材料 硬质合金		红宝石	塑料
	无槽	有槽 (防水型)	无槽	无槽
7.3	901312	—	120047	901994
8.3	21AZA319	902119	—	—
12.1	—	21AZA320	—	—
14	21JAA225	—	—	—
15	120049	—	120051	—
17	21JAA224	—	—	—
19.3	—	21AZA321	—	—
20	137391	—	137392	—
22	21JAA226	—	—	—
25	120053	—	120055	—
30	21AAA252	—	21AAA253	—

壳型测针

大半径测针

最适宜用于平整表面

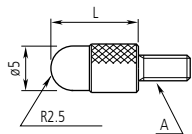

A: M2.5x0.45

L	货号
5	101386
10	101118
15	137393
20	101387
25	101388
30	21AAA254

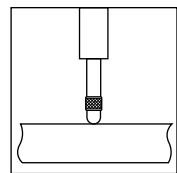

钢球测针

最适宜用于具有深压痕的工件

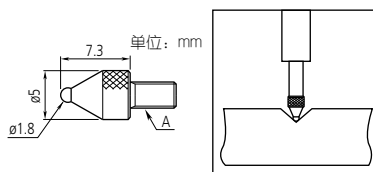

A: M2.5x0.45

SøD	ød	货号
1mm, 硬质合金	5mm	21AAA349
1.5mm, 硬质合金	5mm	21AAA350
1.8mm, 钢质	5mm	101122
2.5mm, 硬质合金	5mm	21AAA351
4mm, 硬质合金	5mm	21AAA352

球型测针

大半径使得这种测针最适宜用于需向一侧滑动的工件

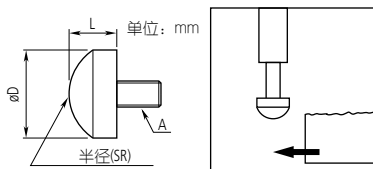

A: M2.5x0.45

D	L	SR	货号
5.5	3	5	111460
7.9	5	5	125258
10	5	7	101119

球型测针 (硬质合金)

大半径使得这种测针最适宜用于需向一侧滑动的工件

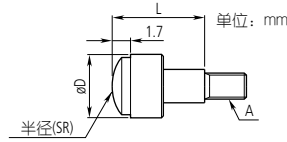

A: M2.5x0.45

D	L	SR	货号
5.2	5	5	120058
7.5	10	7	120059
10.5	10	10	120060

锥型测针

用于测量点定位。因其易于损坏工件，不宜用于柔软材质

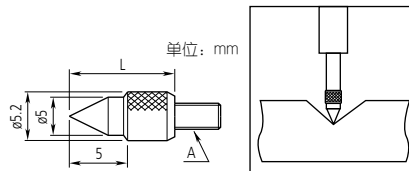

A: M2.5x0.45

顶尖角度	L	货号
60°	10	101120

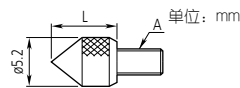

A: M2.5x0.45

顶尖角度	L	货号
90°	5	101385

刀刃型测针 (硬质合金)

适用于测量狭窄沟槽直径等

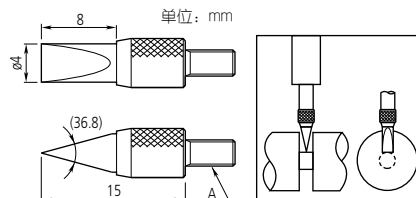

A: M2.5x0.45

货号
120067

锥型测针 (硬质合金)

用于测量点定位。因其易于损坏工件，不宜用于柔软材质

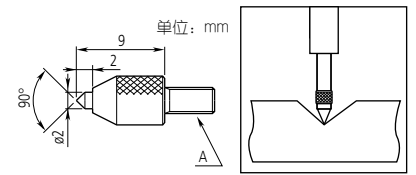

A: M2.5x0.45

货号
120057

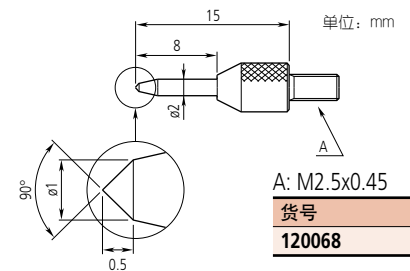

A: M2.5x0.45

货号
120068

平面测针

最适宜用于凸表面

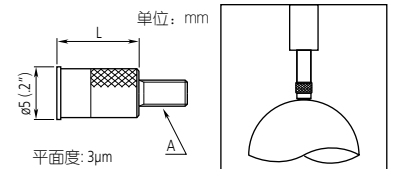

A: M2.5x0.45

L	货号
8	131365
10	21AAA340

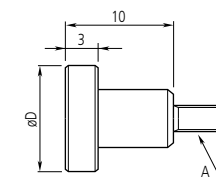

A: M2.5x0.45

D	货号
10	10117
15	21AAA341
20	21AAA342
25	21AAA343
30	21AAA344

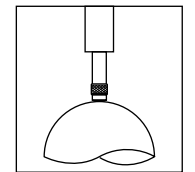

平面测针 (硬质合金)

最适宜用于凸表面

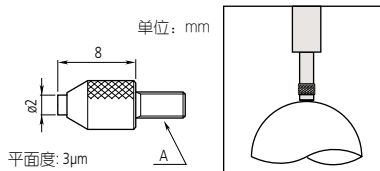

A: M2.5x0.45

货号
120056

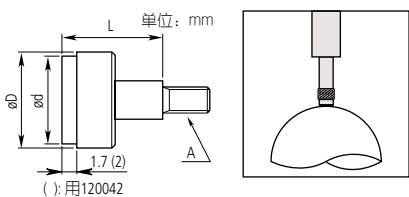

A: M2.5x0.45

D	d	L	货号
5.2	4.3*	5	120041
7	6.5*	10	120042
10.5	9.5*	10	120043
17	15**	10	21AAA345
22	20**	10	21AAA346
27	25**	10	21AAA347
32	30**	10	21AAA348

平面度: *3µm, **5µm

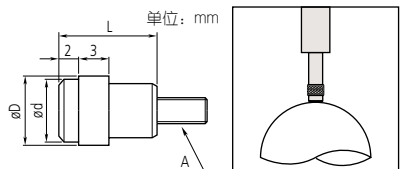

A: M2.5x0.45

D	d	L	货号
7	6.4	10	137255
9	8	10	137399

杠杆测针

适用于平行表面, 如模具型腔内的平行表面。杠杆可调节至所要求的角度。

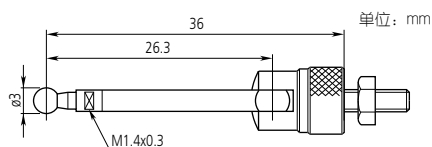

A: M2.5x0.45

货号
900391

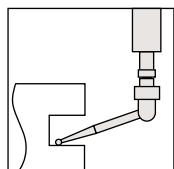

针型测针

适用于探测凹槽或孔洞的底部

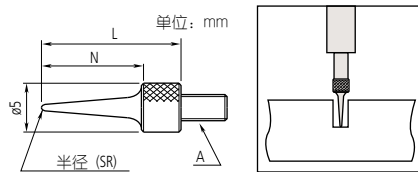

A: M2.5x0.45

N	L	SR	货号
11	15	0.4	101121
13	17	0.2	137413
21	25	0.4	21AAA255
31	35	0.4	21AAA256

针型测针 (硬质合金)

适用于探测凹槽或孔洞的底部

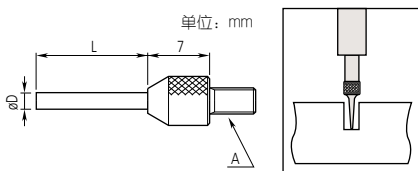

A: M2.5x0.45

D	L	货号
0.45	3	120066
0.45	5	21AAA329
1	3	120065
1	5	21AAA330
1	8	21AAA331
1	10	21AAA332
1.5	5	21AAA335
1.5	10	21AAA336
1.5	13	120064
1.5	20	21AAA337
1.5	40	21AAA338
2	8	137257
2	18	21AAA257
2	28	21AAA258
2	40	21AAA339

叶片型测针 (硬质合金)

适用于凸表面，特别是具有浅凹槽的凸表面

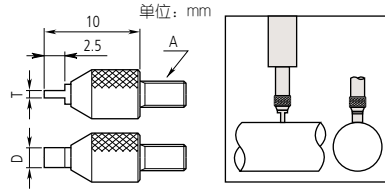

A: M2.5x0.45

T	W	货号
0.4	2	120061
0.6	2	120062
1	4	120063

滚轴型测针

适用于活动工件表面，或工件须向一侧滑动的表面

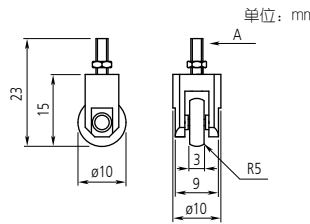

A: M2.5x0.45

货号
901954

延长杆

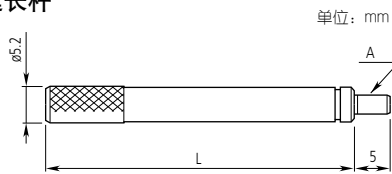

A: M2.5x0.45

L	货号
10	303611
15	21AAA259A
20	303612
25	21AAA259B
30	303613
35	21AAA259C
40	21AAA259D
45	21AAA259E
50	21AAA259F
55	21AAA259G
60	304146
65	21AAA259H
70	21AAA259J
75	21AAA259L
80	21AAA259M
90	304147
100	303614

可更换测针套装

本套装包含六种类型的常用测针，确保指示表有多种应用



A: M2.5x0.45

货号	部件
7822	平面测针 (131365, ø5mm)
	平面测针 (101117, ø10mm)
	针型测针 (101121)
	球型测针 (101119)
	壳型测针 (101118)
	壳型测针 (101387)